



Technical Data Sheet

AWAZEL DIMPLE SHEET

HDPE Sheet of Special Structure

DIMPLE SHEETS

DESCRIPTION

AWAZEL DIMPLE SHEET is a non bio-degradable HDPE Sheet of special structure.

ADVANTAGES

- Permanent air gap for the underground structure
- Excellent compressive strength (400 kN/m²) due to the special structured dimple of 10 mm height and density space to give very high protection.

USES

For high protection of waterproofing that may be punctured by the back filling.
For full surface ventilation
For rot-proof and impervious to root penetration.

INSTRUCTIONS FOR APPLICATION

Easy application by using the fixation method utilizing metallic profile, adhesive tape or other mechanical fixation; apply on overlap of around 12 cm.

PACKING

It is produced in roll of 2 m wide and 12 / 20 meters length. The rolls are palletized and shrink-wrapped.

HEALTH & SAFETY

This product is non toxic. During application, the worker should wear personnel protective tools such as gloves and goggles.

STORAGE

Store in dry place protected from sun, heat & water.

AWAZEL DIMPLE SHEET

HDPE Sheet of Special Structure

Protective Sheet for foundation walls and civil works

| Properties | Typical Value |
|---|---|
| Material Structure: Dimple Sheet | HDPE |
| Color | Green / Blue |
| Area Weight, g/m ² | 600 |
| Sheet Width, m | 2 |
| Dimple Height, mm (ASTM D 1777) | 10 |
| Air Gap between Dimples, l/m ² | 7.9 |
| Compressive Strength, kN/m ² (ASTM D 6364) | 400 |
| Chemical Properties | Excellent Chemical Resistance Resistant to Root Penetration Rot-proof |
| Service Temperature, °C | -40 to +80 |

DIMPLE SHEET USAGES

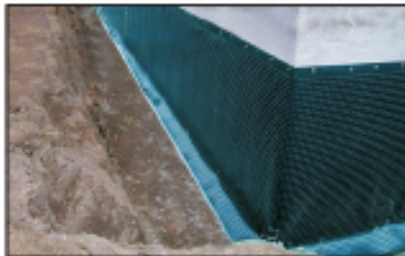

External Wall Protection

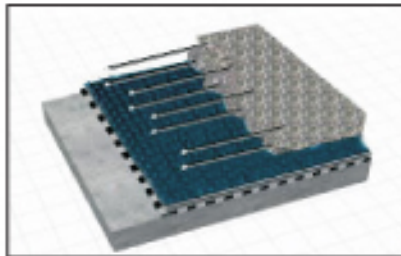

Horizontal Waterproofing
Protection

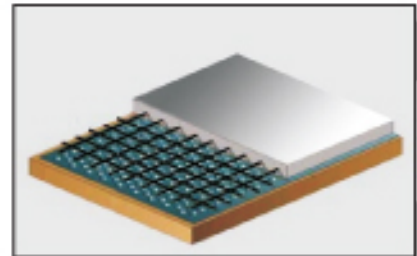

Horizontal Protection
Under Raft Foundation

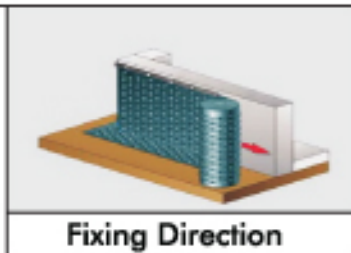
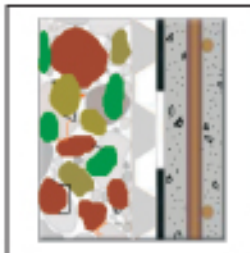

Fixing Direction

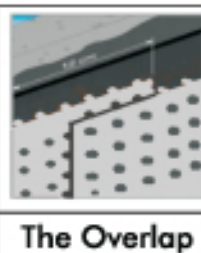

The Overlap

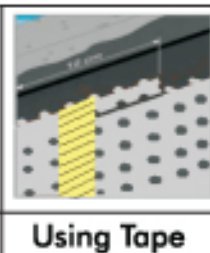

Using Tape



By Metal Profile



Technical Data Sheet

AWAZEL DIMPLE SHEET-D 700

HDPE Sheet of Special Structure, Thermally Bonded to a Non-Woven
Calendared Polypropylene

DESCRIPTION

AWAZEL DIMPLE SHEET is a non-bio-degradable HDPE Sheet of special structure, thermally bonded to a non-woven calendared polypropylene of 100 g/m²

ADVANTAGES

- Excellent drainage performance
Permanent air gap for the underground structure
- Excellent compressive strength of 420 kN/m² due to the special structured dimple of 10 mm height and density space to give very high protection.

USES

For high protection of waterproofing that may be punctured by the back filling.
Allows drainage of accumulated water and minimizing the hydration pressure
The non-woven Geo-textile is creating air gap for reliable ventilation of soil.
This could be used very effectively for Green Roofs.

INSTRUCTIONS FOR APPLICATION

Easy application by using the fixation method utilizing metallic profile, adhesive tape or other mechanical fixation; apply on overlap of around 12 cm.

PACKING

It is produced in roll of 2 m wide and 12 / 20 meters length. The rolls are palletized and shrink-wrapped.

HEALTH & SAFETY

This product is non toxic. During application, the worker should wear personnel protective tools such as gloves and goggles.

STORAGE

Store in dry place protected from sun, heat & water.

AWAZEL DIMPLE SHEET-D 700

HDPE Sheet of Special Structure, Thermally Bonded to a Non-Woven Calendared Polypropylene

Protective Drainage Sheet for Foundation Walls

| Properties | Typical Value |
|--|---|
| Material Structure: Dimple Sheet Geo Textile | HDPE |
| Color: Dimple Sheet Geo Textile | Green / Blue Gray / White |
| Area Weight, g/m ² | 700 |
| Sheet Width, m | 2 |
| Dimple Height, mm (ASTM D 1777) | 10 |
| Air Gap between Dimples, l/m ² | 7.9 |
| Drainage Capacity | 4.8 l/s/m=288 l/min/m=17,288 l/h/m |
| Compressive Strength,kN/m ² (ASTM D 6364) | 420 |
| Chemical Properties | Excellent Chemical Resistance Resistant to Root Penetration Rot-proof |
| Service Temperature, °C | -40 to +80 |

DIMPLE SHEET USAGES

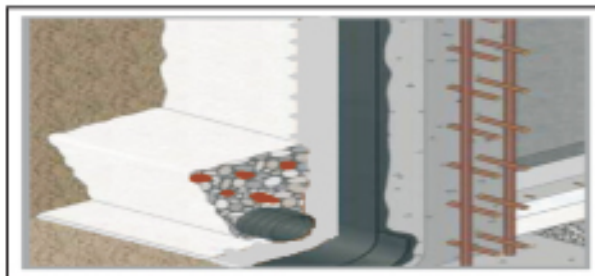

External Wall Drainage& Protection

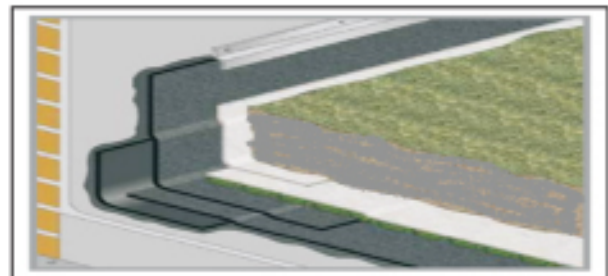

Green Roofs

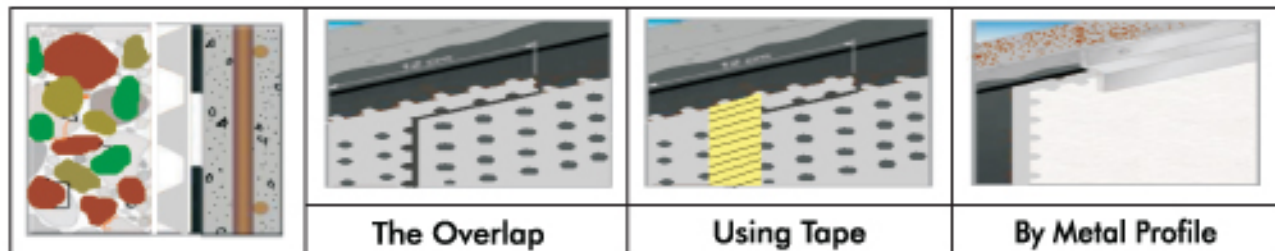

The Overlap

Using Tape

By Metal Profile



Technical Data Sheet

AWAZEL DIMPLE SHEET-D 850

HDPE Sheet of Special Structure, Thermally Bonded to a Non-Woven Calendared Polypropylene.

DESCRIPTION

AWAZEL DIMPLE SHEET is a non-bio-degradable HDPE Sheet of special structure, thermally bonded to a non-woven calendared polypropylene of 135 g/m². It has distinctive advantage in under water tunnels, metro tunnels, railway tunnels and more.

ADVANTAGES

- Excellent drainage performance
- Permanent air gap for the underground structure
- Excellent compressive strength of 480 kN/m² due to the special structured dimple of 10 mm height and density space to give very high protection.

USES

For high protection of waterproofing that may be punctured by the back filling.
Allows drainage of accumulated water and minimizing the hydration pressure.
The non-woven Geo-textile is creating air gap for reliable ventilation of soil.

INSTRUCTIONS FOR APPLICATION

Easy application by using the fixation method utilizing metallic profile, adhesive tape or other mechanical fixation; apply on overlap of around 12 cm.

PACKING

It is produced in roll of 2 m wide and 12 / 20 meters length. The rolls are palletized and shrink-wrapped.

HEALTH & SAFETY

This product is non toxic. During application, the worker should wear personnel protective tools such as gloves and goggles.

STORAGE

Store in dry place protected from sun, heat & water.

AWAZEL DIMPLE SHEET-D 850

HDPE Sheet of Special Structure, Thermally Bonded to a Non-Woven Calendared Polypropylene.

Protective Drainage Sheet for Tunnels

| Properties | Typical Value |
|---|---|
| Material Structure: Dimple Sheet Geo-textile | HDPE PP |
| Color: Dimple Sheet Geo-textile | Silver Grey / White |
| Weight of Materials, g/m ² : Dimple Sheet Geo-textile | 715 135 |
| Area Weight, g/m ² | 850 |
| Sheet Width, m | 2 |
| Dimple Height, mm (ASTM D 1777) | 10 |
| Air Gap between Dimples, l/m ² | 7.9 |
| Drainage Capacity | 4.8 l/s/m=288 l/min/m=17,288 l/h/m |
| Compressive Strength, kN/m ² (ASTM D 6364) | 480 |
| Chemical Properties | Excellent Chemical Resistance Resistant to Root Penetration Rot-proof |
| Service Temperature, °C | -40 to +80 |

DIMPLE SHEET Usage - Tunnel Application

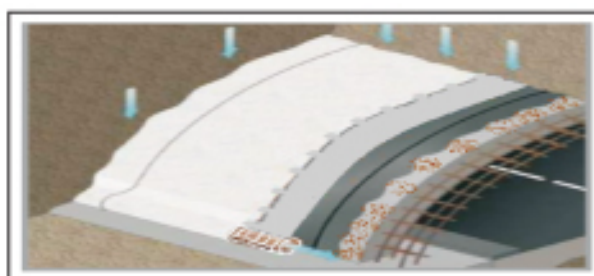

DIMPLE SHEET FIXATION METHODS

